



INSTRUCTIONS

-J03994

REV. 2006-07-01

BASEPLATE KIT

GENERAL

Kit Number

51120-07, 51138-07, 51220-07

Models

Table 1. Models

Kits	Models
51138-07	2007 VRSCAW, VRSCX, and VRSCDX
51220-07	2007 VRSCAW, VRSCX, and VRSCDX
51120-07	2007 VRSCD

Kit Contents

See Figure 9 and Table 2.

INSTALLATION

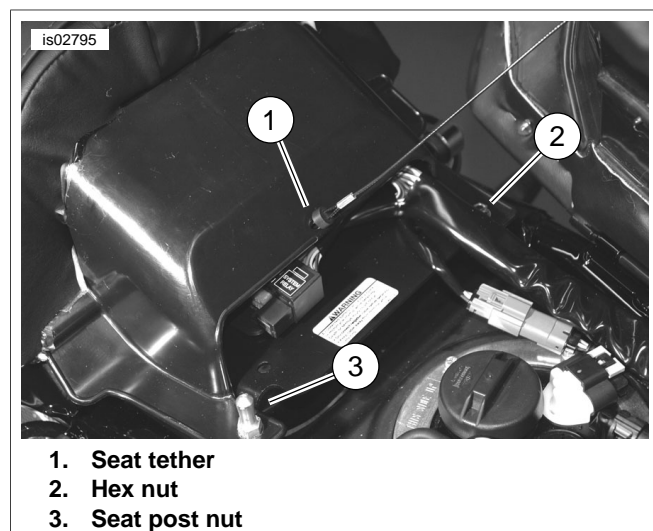

Figure 1. Remove Pillion

1. See Figure 1. Open rider's seat and remove tether (1) from pillion base.
2. Remove and save seat post nut (3) and hex nut (2) from the pillion base for reinstallation. Lift pillion tabs off frame studs and push the pillion forward to release bottom of the pillion from pillion post on fender. Lift the pillion away from the motorcycle and temporarily set aside.

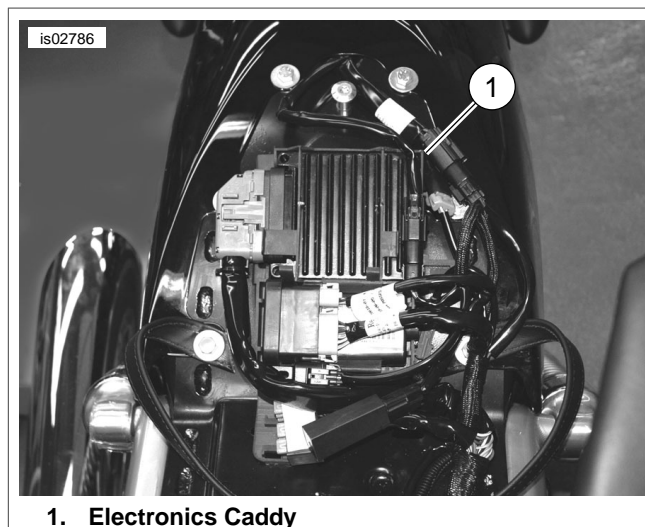

Figure 2. Remove Electronics Caddy

3. See Figure 2. Make note of electronics caddy location and wiring routes under pillion base. Press on the caddy's retaining tabs and remove the caddy from the fender. Move the caddy and wiring to the side.

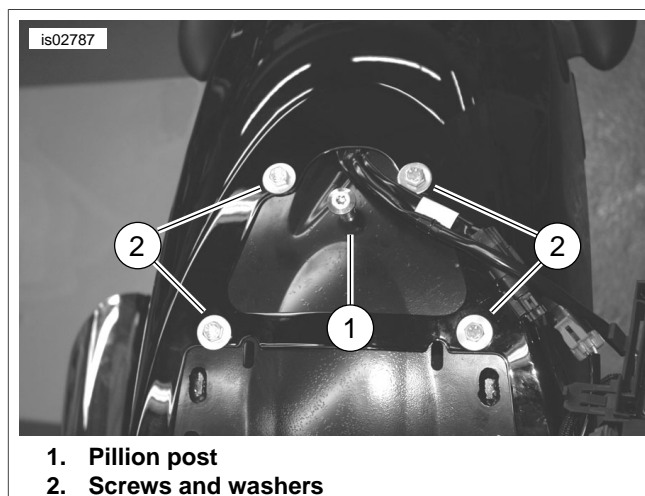

Figure 3. Remove Fender Support Screws and Washers

4. See Figure 3. Remove the four fender support screws and washers (2). Discard screws, but save three washers for re-installation. From under the fender use an allen wrench to hold the lower pillion screw while removing the upper pillion post (1). Save the pillion post and lower washer for reinstallation.
5. Thoroughly clean fender at pillion mounting area of all dirt and debris.

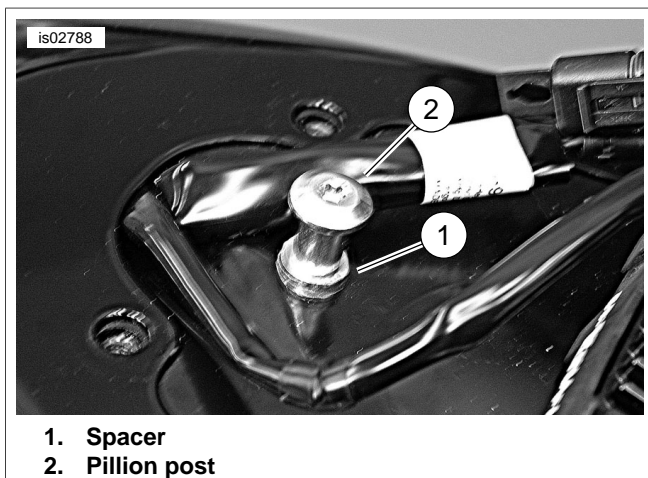

Figure 4. Install Pillion Post and Spacer

6. See Figure 4. Insert allen screw, washer and lockwasher from kit through fender. Insert spacer (1) from kit and pillion post from top side of seat pan and tighten to 10.9-17.6 Nm (8-13 ft-lbs).
7. See Figure 9. Obtain baseplate (1) and baseplate gasket (2) from kit.
8. Using isopropyl alcohol at full strength, thoroughly clean the mounting side of the baseplate. Let dry completely.

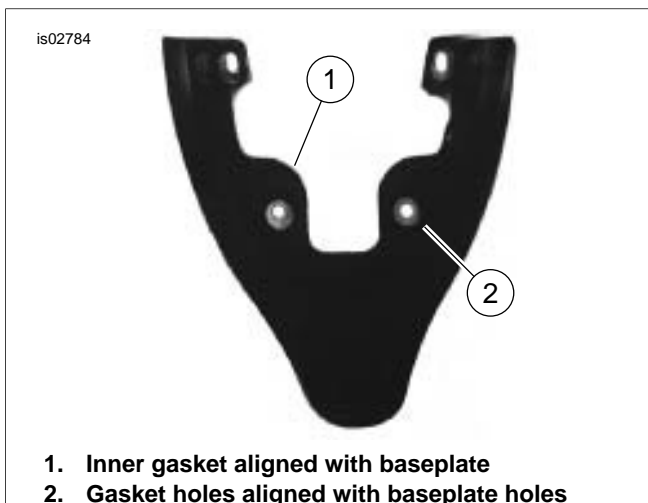

Figure 5. Install Gasket to Baseplate

9. See Figure 5. Remove the paper backing covering the gasket adhesive. Carefully align the adhesive side of gasket over the back of the baseplate and work around inner edges. Make sure gasket is aligned and adheres along the entire baseplate edges (1) as shown.

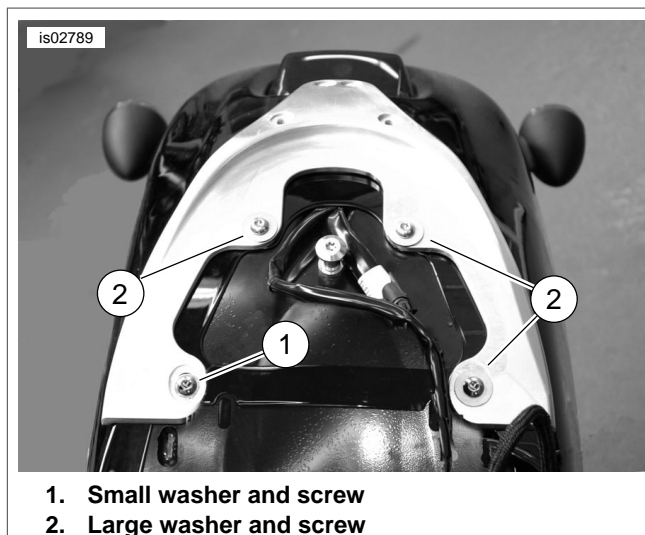

Figure 6. Install Baseplate Mounting Hardware

10. See Figure 6. Carefully align the baseplate (with gasket) over the screw holes in the top of the fender. Obtain the four large button head screws and small flat washer from kit. Also obtain the large flat washers saved in Step 4.
11. Install the one screw (1) with small washer through the baseplate at the recessed slot, gasket and into the fender and finger tighten.
12. Install three screws (2) with large washers through the baseplate, gasket and into the fender. Finger tighten.

NOTE

The smaller flat washer must fit in the recess in the baseplate for clearance gap between electronics caddy wire harness plug.

13. Adjust the baseplate, if necessary, to make sure it is aligned (parallel) with the fender. Alternately tighten all four screws to 8-12 Nm (71-106 in-lbs).



Figure 7. Electronics Caddy Installation

14. See Figure 7. Install the electronics caddy on fender. Make sure that there is clearance between wire harness plug and base mounting screw.
15. While applying downward pressure on the middle of the pillion, slide the pillion at a slight angle rearward to fully engage the slot on the bottom with the pillion post on

fender. Push rearward until the mounting tabs on the pillion base is aligned with frame studs.

16. Obtain seat post nut and hex nut saved in Step 2 and install to secure pillion base to frame. Tighten nuts to 11-17 Nm (97-150 **in-lbs**).
17. Install the rider's seat tether in hole in pillion base.

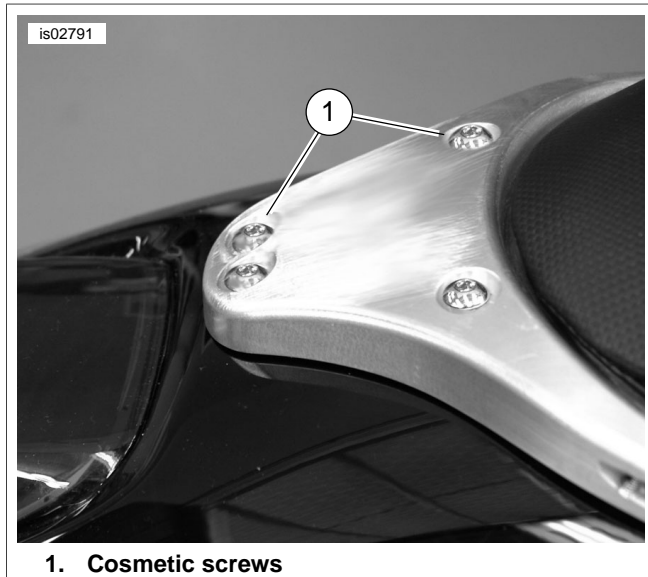

Figure 8. Install Cosmetic Screws

NOTE

The screws installed in the next step serve as "Cosmetic" screws. These screws will be removed when optional accessories such as Luggage Rack or Sissy Bar are added.

18. See Figure 8 and Figure 9. Obtain four screws (1) from kit. Install the four (cosmetic) screws into the holes at the rear of the baseplate. Tighten screws to 28 Nm (21 ft-lbs).

SERVICE PARTS

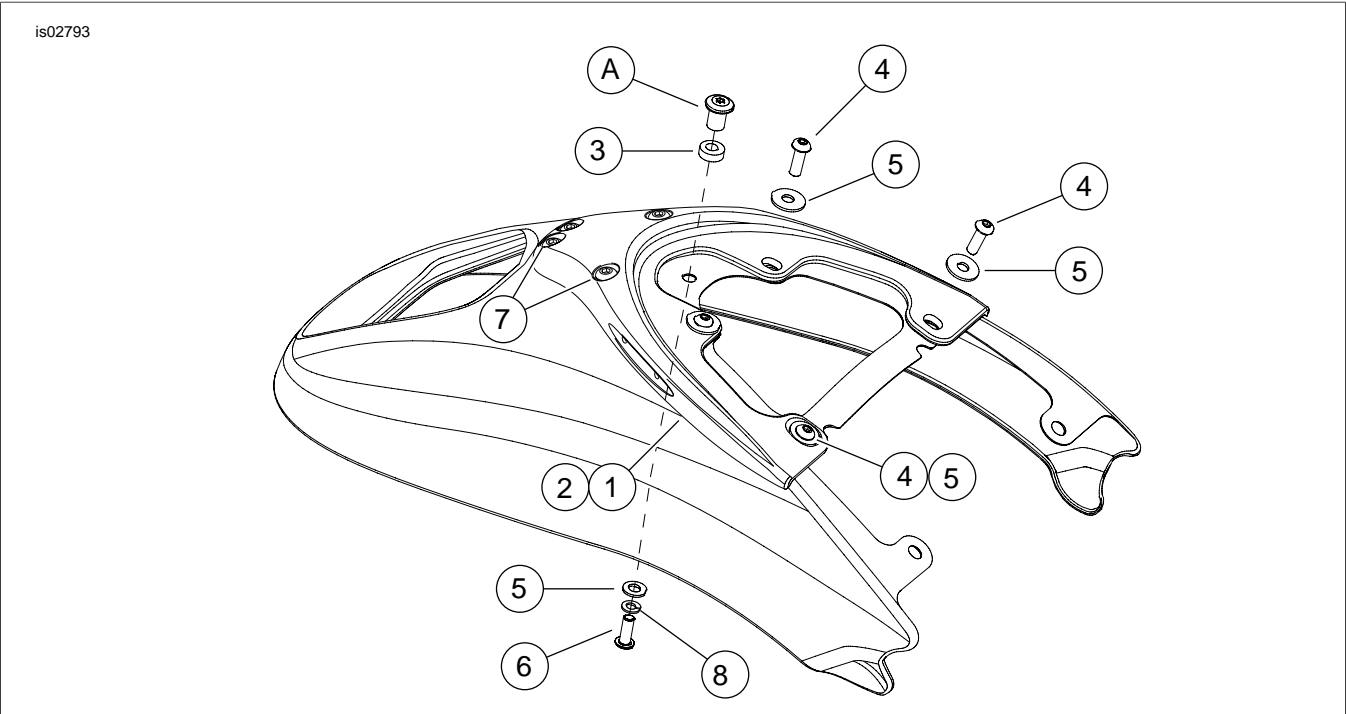

Figure 9. Service Parts: Baseplate Kit

Table 2. Service Parts Table

Item	Description (Quantity)	Part Number
1	Baseplate	Not Sold Separately
2	Baseplate gasket (not shown)	51123-07
3	Spacer, pillion post	6744
4	Fender bolt (4)	4772M
5	Washer (5)	6333
6	Pillion post bolt	4359
7	Decorative screw (4)	4472M
8	Lockwasher	7041
Items mentioned in text, but not included in kit:		
A	Pillion post	